

Induction Hotend Latch Replacement for the H2C

This article will provide you with a detailed guide on the step-by-step process and important considerations for replacing the induction hotend latch on your H2C.

H2C Induction Hotend Latch

The Induction Hotend Latch enables quick locking and unlocking of the hotend assembly. It integrates miniature magnets that work with the Hall sensor on the heating module, allowing the printer to automatically detect whether the hotend is in the locked or released state.

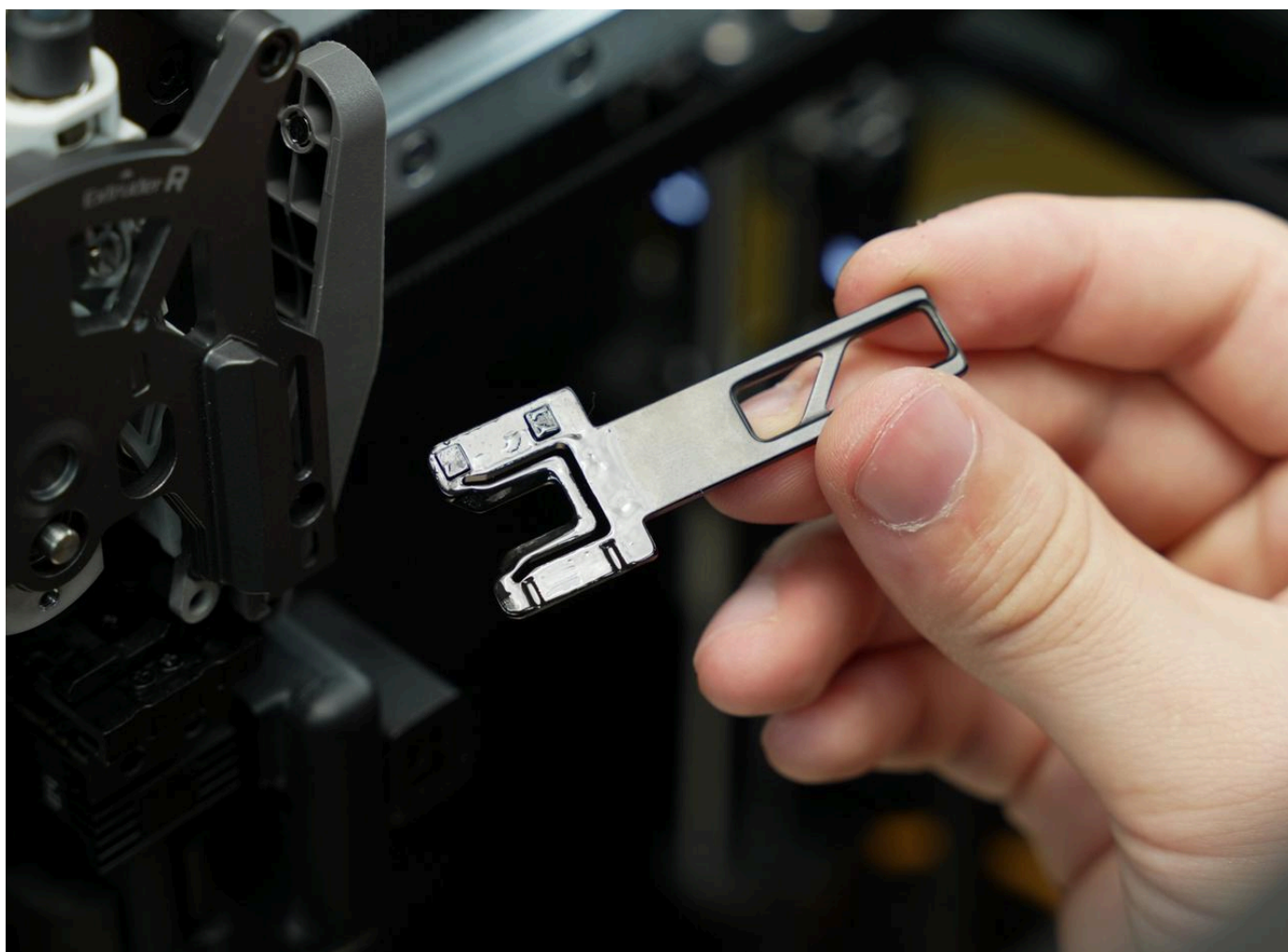

When to Use this Guide

- ▶ Damaged induction hotend latch
- ▶ Wear of the induction hotend latch

Required Tools and Materials

- ▶ New induction hotend latch
- ▶ lubricating oil

- H2.0 Hex wrench

Safety Warning

It's crucial to **power off the printer before conducting any maintenance work**, including work on the printer's electronics and tool head wires. Performing tasks with the printer on can result in a short circuit, leading to electronic damage and safety hazards.

During maintenance or troubleshooting, you may need to disassemble parts, including the hotend. This exposes wires and electrical components that could short circuit if they contact each other, other metal, or electronic components while the printer is still on. **This can result in damage to the printer's electronics and additional issues.**

Therefore, it's crucial to **turn off the printer and disconnect it from the power source before conducting any maintenance**. This prevents short circuits or damage to the printer's electronics, ensuring safe and effective maintenance. For any concerns or questions about following this guide, [open a new ticket in our Support Page](#)  and we will do our best to respond promptly and provide the assistance you need.

Video Guide



Bambu Lab H2C Vortek Hotend Latch Replacement

Bambu Lab Support



0:22 / 1:58



Další videa



Removing the Old Induction Hotend Latch

Step 1: Remove the Hotend

Left Nozzle: Remove the silicone sleeve, open the fixing clip, and take out the left nozzle assembly.

Right Nozzle: Pull the nozzle handle to the right to unlock and remove the right nozzle assembly.



Step 2: Remove the Extruder Front Cover Guide Assembly

Use your fingers to push the black nozzle connector upward from below while gently pressing the handle of the left cutter to release it from the slot near the cutter screw.

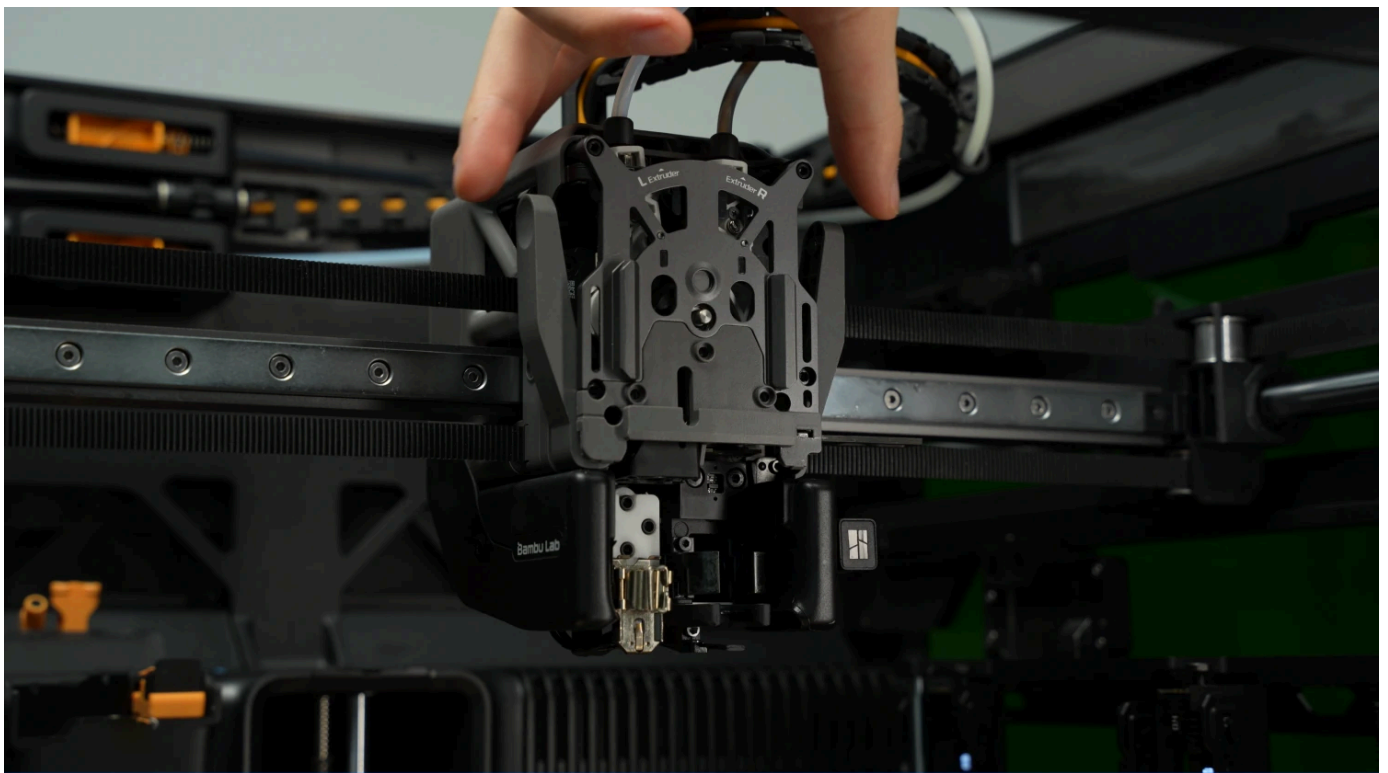

For detailed replacement steps, please refer to the wiki: [H2C Extruder Filament Guide Replacement Steps](#).

Step 3: Remove the Induction Hotend Latch

Pull the latch to the right until it is fully extended

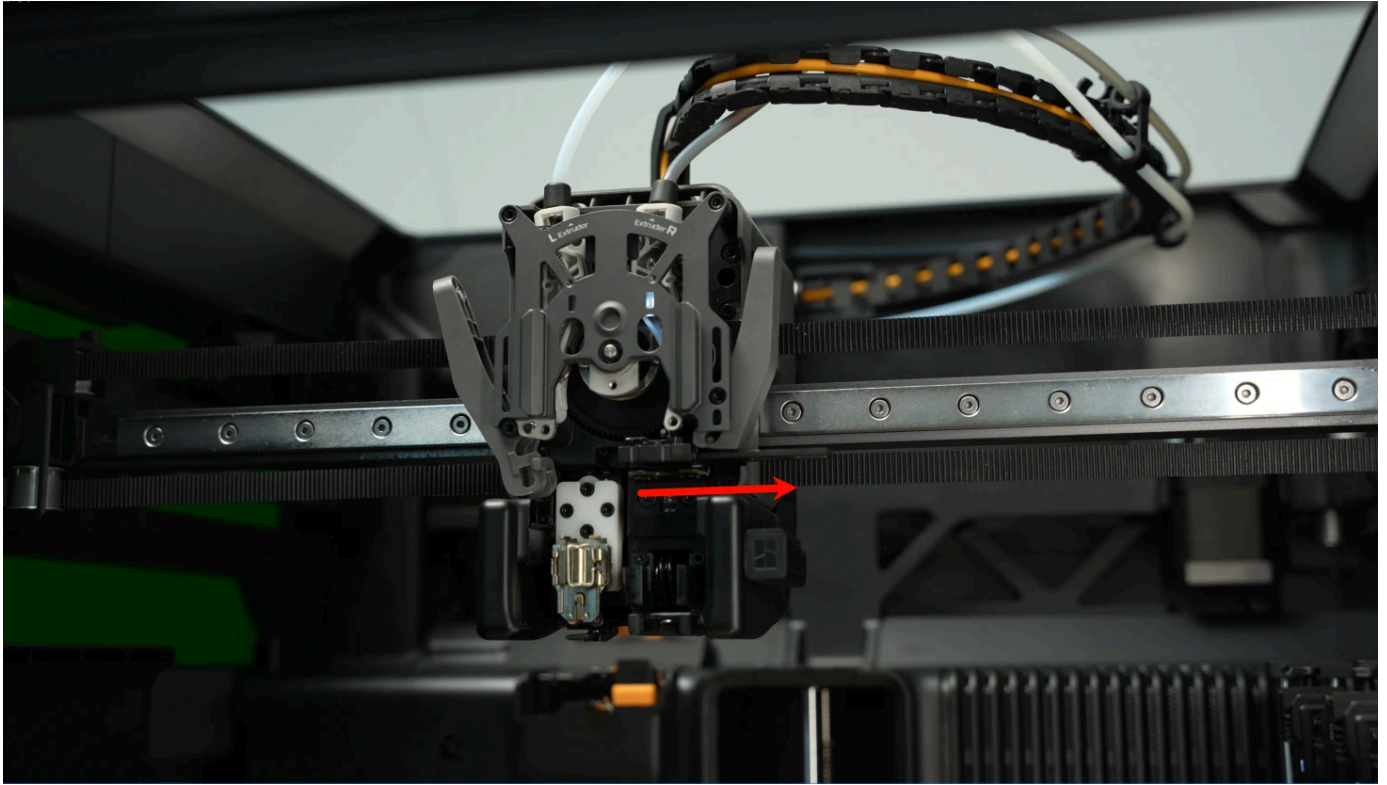

Installing a New Induction Hotend Latch

Step 1: Apply Lubricant to the New Induction Hotend Latch

As shown in the picture, apply lubricant to both sides of the new induction hotend latch slide groove.



Step 2: Install the New Induction Hotend Latch

As shown in the picture below, align the top surfaces of the two small squares on the toolhead with the corresponding grooves, ensuring that the top surface of the latch faces upward.

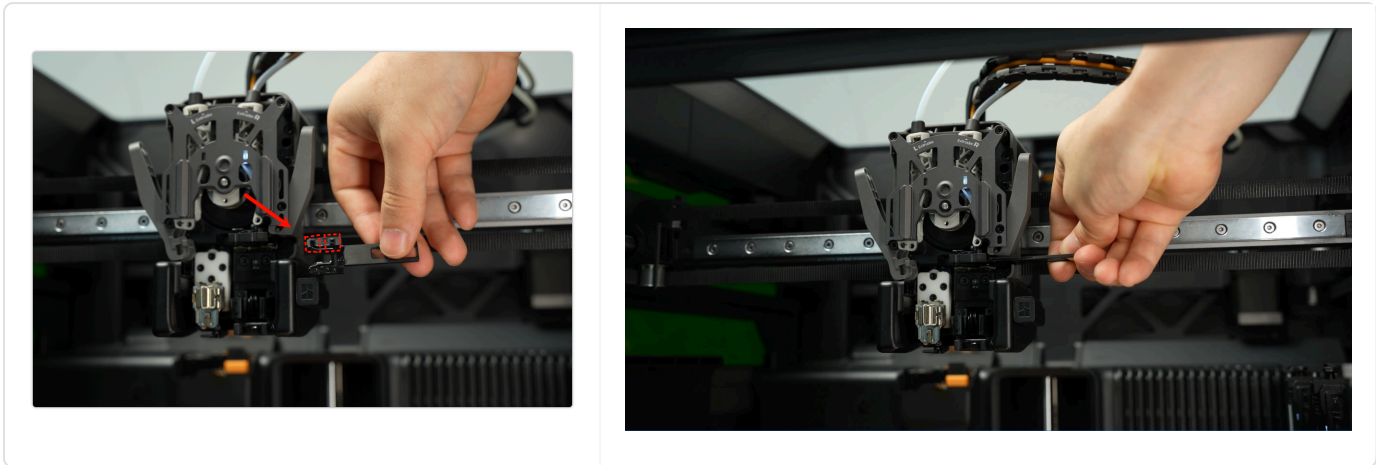

Step 3: Install the Extruder Filament Guide Assembly

Gently press the left cutter to adjust it to a suitable angle for easier insertion, then guide the filament guide into place. Finally, press down on both cutters while pressing the front cover flat.

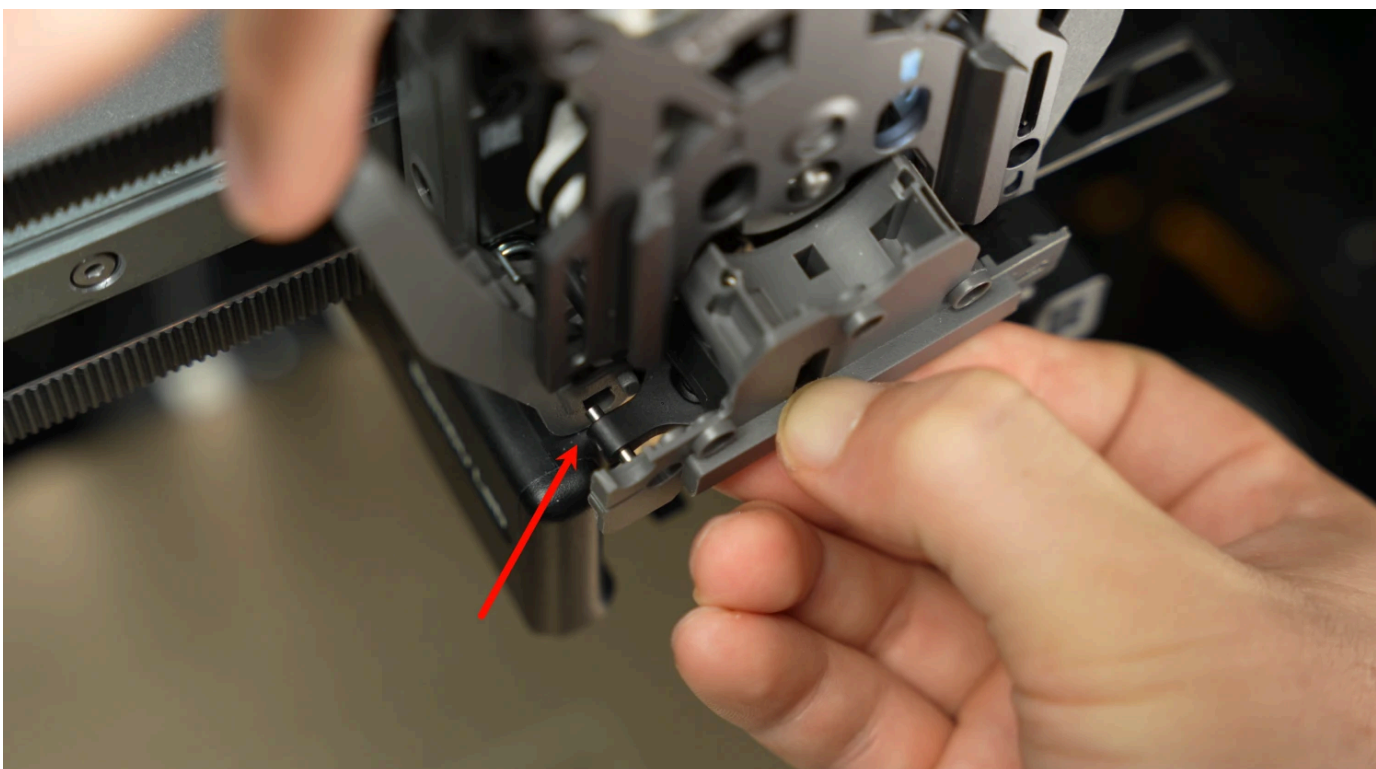

For detailed replacement steps, please refer to the wiki: [H2C Extruder Front Guide Replacement Steps](#).

Step 4: Install the Hotend

Left nozzle installation : Place the left nozzle assembly into the corresponding mounting position, fasten the fixing clip, and ensure the nozzle is secure. Then reinstall the silicone sleeve on the left nozzle.

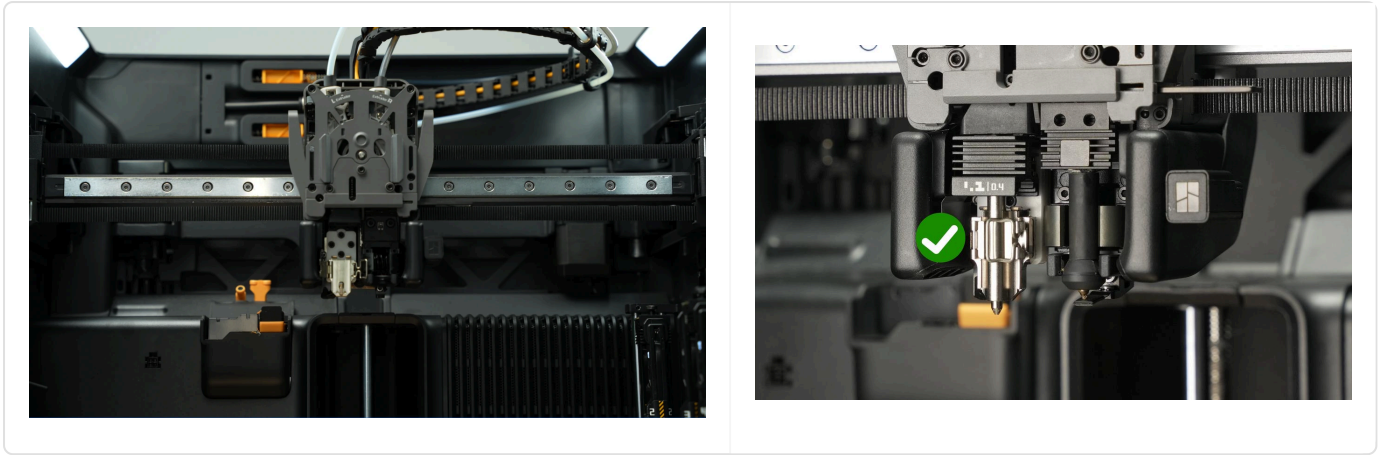

Right nozzle installation: Ensure the pull handle is extended, align the right nozzle assembly with the mounting position, and push it in. Then press the pull handle to lock it in place. Gently shake the nozzle to confirm it is securely locked and not loose.

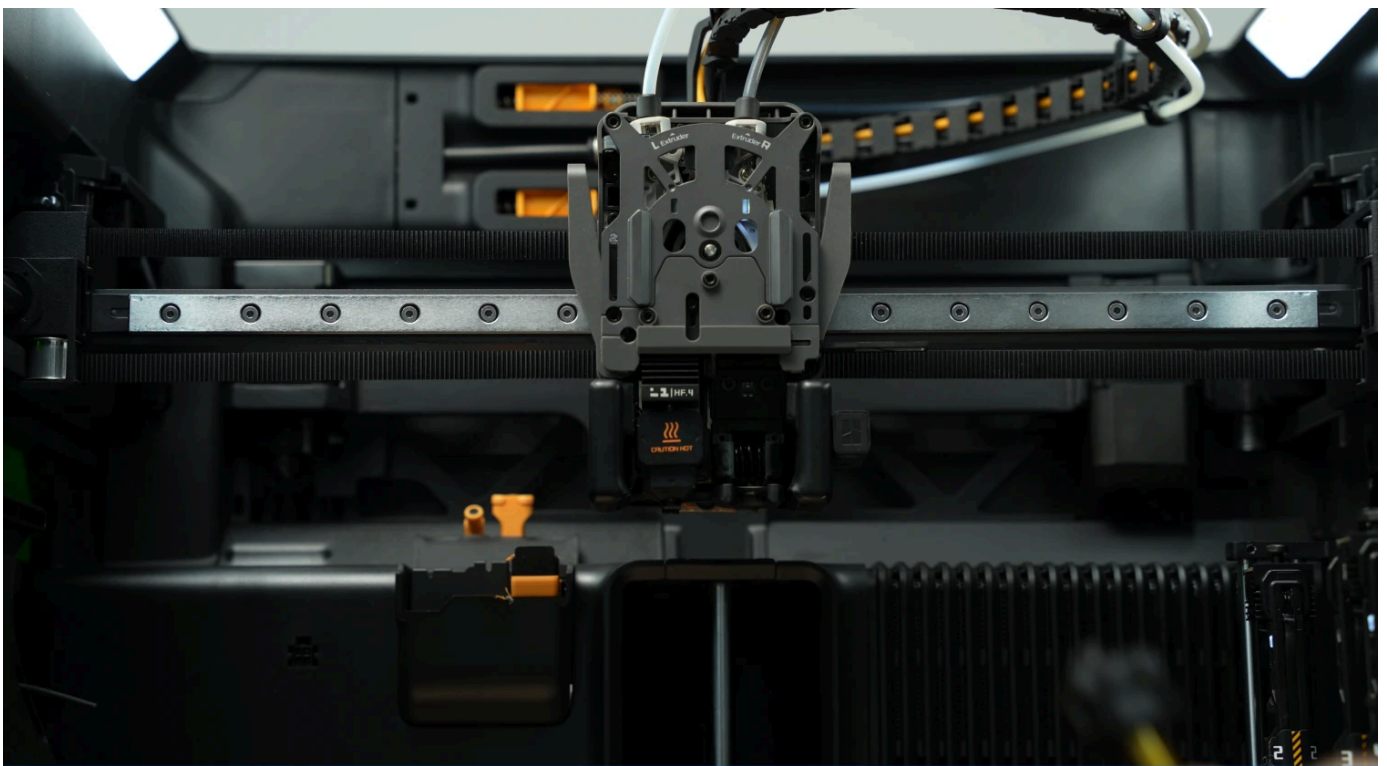

For detailed installation steps, please refer to the wiki: [H2C Induction Hotend Installation Guide](#).

Verifying Functionality

Gently shake the hotend to confirm that the locking handle of the induction hotend securely locks the right hotend in place.

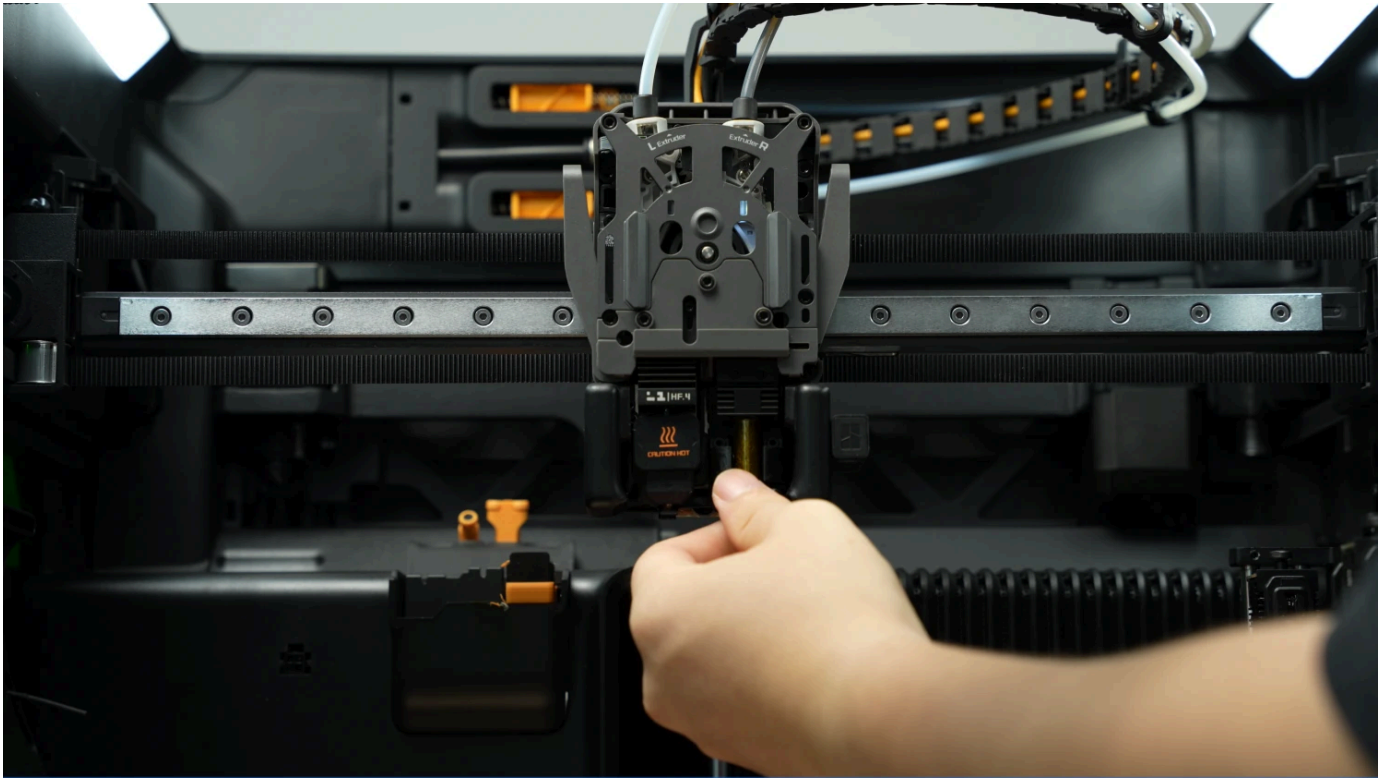

End Notes

We hope this guide has provided clear and practical support.

If the issue remains unresolved, please submit a [support ticket](#)  and include your recent printer logs and additional pictures or other details. Our technical team will review your request and provide detailed assistance.

You can also visit [Bambu AI](#) , which can instantly answer common questions and provide you with operational guidance.